

NO. G18012

B

2019 1 4

.....	1
.....	3
.....	4
.....	13
.....	27
.....	38

1			B 219
2			49.727613 ()
3			90
4	2.1		
5	3		
6	9		
7	12		6000
8	13		90
9	14		EXCEL U WORD U
10	5		2019 3 4 14 30 18 1# 7 0815
11	6		2019 3 4 14 30 18 1# 8 10
12	21		
13	23		
14	29		

B

B

NO.G18012

B

219

3.1

3

3.2

3.3

3.4

3.5

3.6

2019 3 4 14:30

<http://www.china-fenghua.com>

5.1

6000

2017002109022121938

5.2

2019 3 4 14:30()

5.3

2019 3 4 14:30()

6.1

2019 3 4 14:30()

6.2

18

1# 8 10

18

1# 7 0815

526020

0758-6923099

0758-6923568

kai_xing10@china-fenghua.com

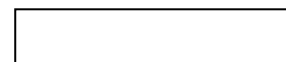

<http://www.china-fenghua.com> OA

fhgkj

1

2

2.1 “ ”

2.2 “ ”

2.3 “ ”

2.4 “ ”

3

18

1# 7 0815

0758-6923099

0758-6923568

<http://www.china-fenghua.com>

4

5

5.1

5.2

5.3

5.3.1

/

5

5.3.2

()

5.3.3

5.3.4

5.4
5.4.1

,

5.4.2
5.4.3

,

5.4.3

6
6.1

6.2
6.3

7
7.1

1
2
3
4
5
6
7
8
9
10
11
12
13
14

8
8.1

“ ” “ ”

“ ”

8.2
9
9.1

9.2
9.3
1
2
3
9.4

9.5

9.6

9.7

9.8

9.9

10

10.1

10.2

10.3

11

11.1

11.2

(1)

(2)

(3)

11.3

11.2 3

12

12.1

RMB 6000

12.2

12.3

2017002109022121938

12.4

12.5

12.6

12.7

(1)

(2)

(3)

(4
12.8

13
13.1 90
13.2

14
14.1 ~~~~~ ~~~~~ “ ” “ ”
14.2

14.3

15
15.1 “ ”
15.2 WRD EXCEL U U 1
“ ” U !“\ ”
15.3 ÁÒÀ ”

20

20.1

20.2

20.3

20.4

20.4

21

21.1

21.2

	3

	6000
	49.727613

21.3

A
B

C
D

E

F

G

H

I

J

21.4

22

22.1

,

22.2

22.3

23

24
24.1
24.2

25
25.1

25.2

26
26.1

1
2
(3)

(4)
(5)
26.2

(1)
(2)

26.3
1
2
(3)
(4)

(5)
(6)
(7)
(8)

26.4
1
2
3
4
5

26.5
1
2
3
4
5
6

27
27.1

27.2

27.3
28
28.1
28.2

28.3

29

30

(1)
(2)
(3)
(4)
(5)
31

(1)
(2)
(3)
(4)
(5)

(1) (5)

32
32.1
32.2

3

7

32.3

7

2

33
33.1

33.2

34
34.1
34.2
34.3
34.4
34.5
35
35.1

35.2
35.3
35.4
35.5
35.6

36
36.1
36.2
36.3
36.4
36.5
36.6

;

37
37.1
37.2
37.3
37.4
37.5

B

B

B

219

- 1.
- 2.
- 3.

2

90
49.727613 ()

50%

20%

40%
10

97%

3%

1.

2

2010

3

4

1.

2

3

4

5

6

7.

500

8

1. B

1

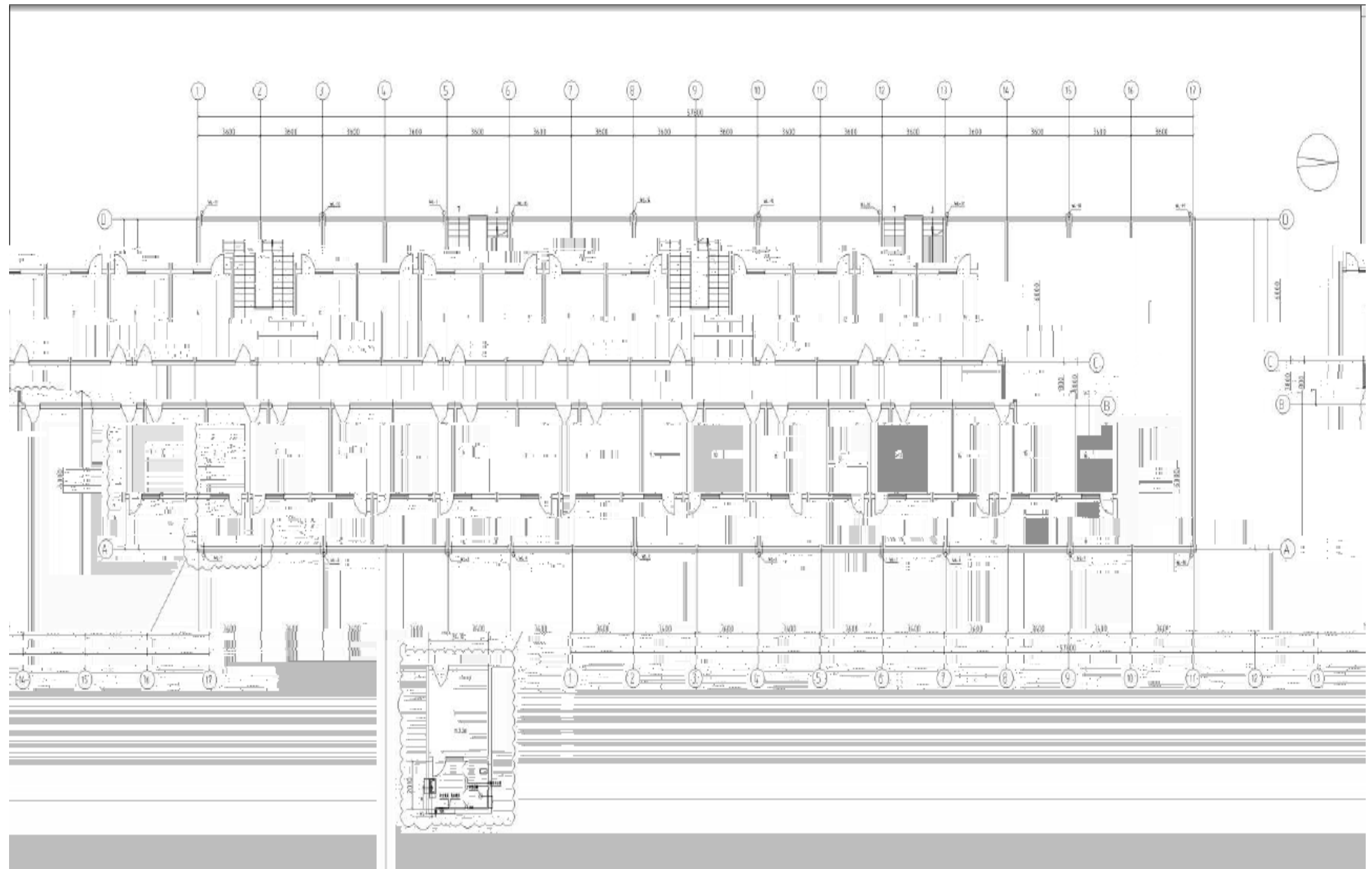

B

_____ ()

_____ ()

_____ ()

_____ ()

_____ ()

B

1

3

		B						
		B						
1	031001006001		1.		m	328.5		
2	031004014001		1.			438		
3			1.			219		
4	030413003001	()	1. DN65 2.			219		
5	030413003002	()	1. DN20 2.			219		
		B						
		B						
6	031004003001		1. 450~500mm 2. 3.			219		
7	011505010001		1. 500*700mm		m ²	54.75		
8	031001006002		1. PP-R, DN20 2. 1.5m		m	867.24		
9	031004014002		1. DN20 2.			219		
	031004014003		1. DN20 2.			219		
11	031004010001		1. 2.			219		
12	031001001001		1. DN20 2. 1.5m		m	503.7		
13	031001006003		1. 65PVC		m	328.5		
	031001006004				m			

B						2	3
15			1.		747		
		B					
16	031301001001				1		
17	031301002001				1		
18	031301003001				1		
19	031301004001				1		
20	031301005001				1		
21	031301006001				1		
22	031301007001	()			1		
23	031301008001				1		
24	031301009001				1		
25	031301010001				1		
26	031301011001				1		
27	031301012001				1		
28	031301013001				1		
29	031301014001				1		
30	031301015001				1		

“ ”

B

3

3

31	031301016001				1			
32	031301017001				1			
33	031301018001				1			

“ ”

/										
1. 2.										
							-		-	
							-		-	

1.
2.

“ ” “ ”

B

2

2

				(%)	()	(%)	()	
11	031302009001			0				Q 20% Q 40%
12	LSSGCSF00001			0				“ 2015 69 ” “ 2018 3 ” “ ” Q 4%

	B			1	1
1				20763.58	
				20763.58	—



B

1

1

() _____

() _____

,
,

1 B _____

2 _____

3 _____

4 _____

5 _____

90 _____ ,

, ,

5%

10 _____ ,

/ 10% 3%

1

1

2
3
2
1
2
3
4

1 50% 20%
40% 10 97%
3% 10
2
1 ;
2 2010
,

3
4 ;
5

3

1

3

2

3

—,

—

48

1

2

7

10

,

3

1

2

3

P

, ,

1

2

3

4

5

6

7

8

1

2

3

4

5

6

7

9

10

11

12

13

14

15

16

17

30

18

19

20

21

22

23

24

25

26

27

28

29

30

31

32

33

34

35

_____ : _____

_____ : _____
_ _ _

施工安全、文明施工承诺书

1	“ ”
2	
3	
1	
2	
3	
4	
5	
6	493

“ ”

7

,
8

9

10

11

12

13

,

14

15

16

17

18

19

20

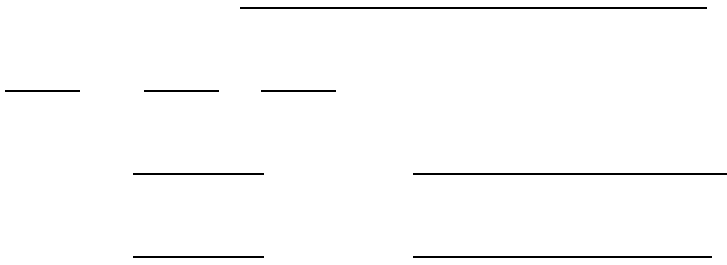

B

WORD

EXCEL

[,]

U U

1.

		3		

1
2 “ ”

2

		6000	
		49.727613	

1
2 “ ”

_____ :

1.

_____ (

) **WORD** **EXCEL** **U** **U** **1**

- 1
- 2
- 3
- 4
- 5
- 6
- 7
- 8
- 9
- 10
- 11
- 12
- 13
- 14

- 1
- 2
- 3
- 4
- 5
- 6

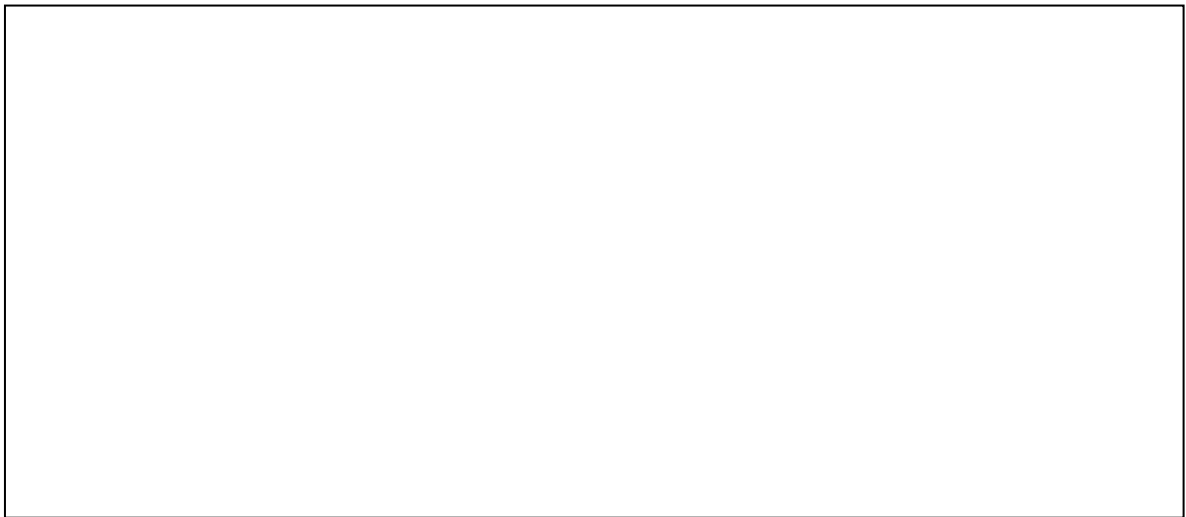

3.

_____ / _____

_____ - _____ - _____ - _____ - _____

_____ - _____ - _____ - _____

_____ - _____ - _____

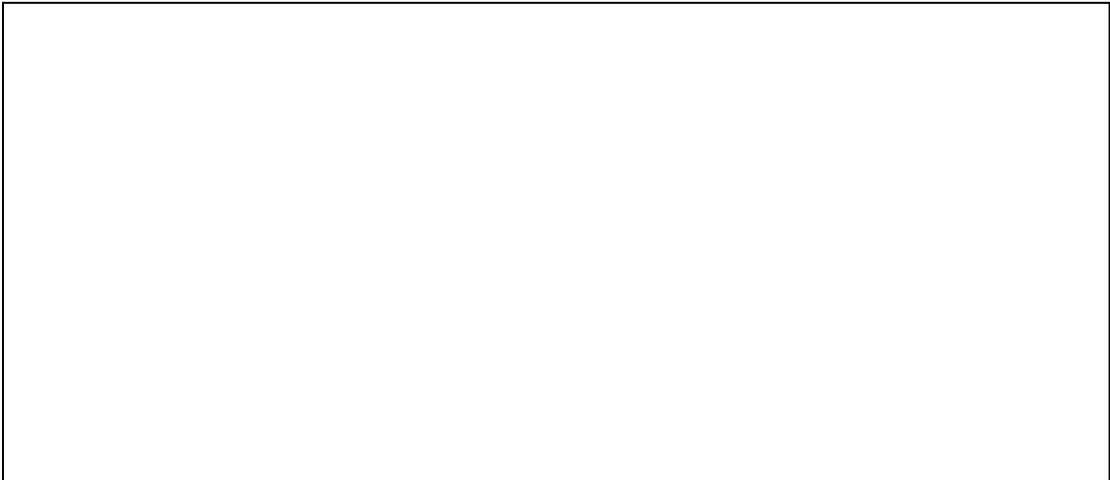

: _____

_____ - _____ - _____

4.

B _____

NO G18012

1. _____

2.

3.

4.

5.

6.

5.

B _____

NO _____

G18012

1

2

3

4

5

7

7

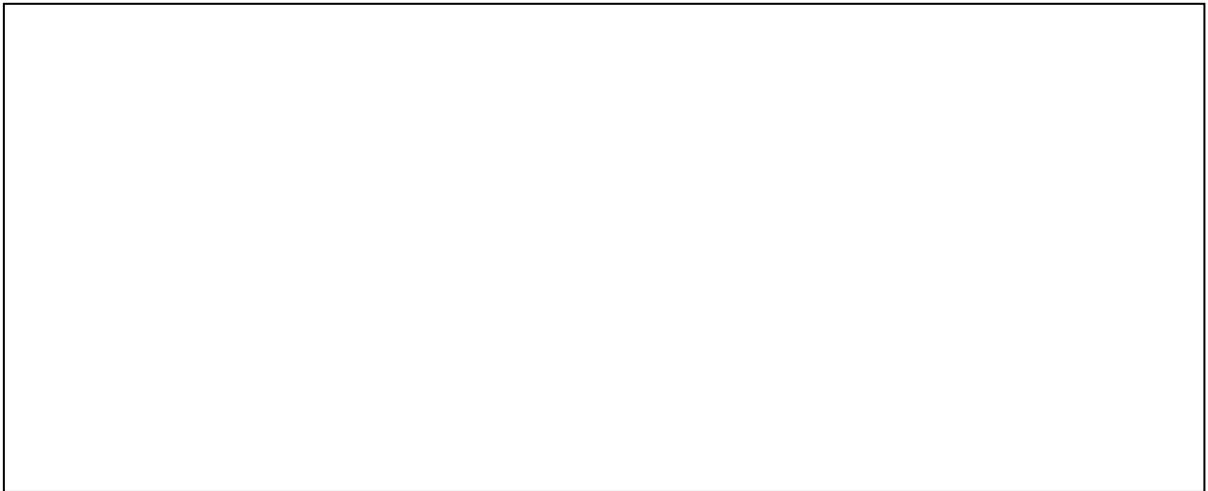

: _____

6.

					E-mail :
					E-mail :
			/	/	
	2015	2016	2017		
		2015	2016	2017	
	ISO9000				
	ISO14000				

7.

_____ : _____

8

_____ : _____



10

NO G18012

1

12

B

()

()

()

B

1

3

		B						
		B						
1	031001006001		1.		m	328.5		
2	031004014001		1.			438		
3			1.			219		
4	030413003001	()	1. DN65 2.			219		
5	030413003002	()	1. DN20 2.			219		
		B						
		B						
6	031004003001		1. 500mm 2. 3.			219		
7	011505010001		1. 500*500mm		m ²	54.75		
8	031001006002		1. PP-R, DN20 2. 1.5m		m	867.24		
9	031004014002		1. DN20 2.			219		
10	031004014003		1. DN20 2.			219		
11	031004010001		1. 2.			219		
12	031001001001		1. DN20 2. 1.5m		m	503.7		
13	031001006003		1. 65PVC		m	328.5		
14	031001006004		1. PVC 110 2. 1.5m		m	501.6		
		B						

“ ”

B				2	3
15			1.	747	
		B			
16	031301001001			1	
17	031301002001			1	
18	031301003001			1	
19	031301004001			1	
20	031301005001			1	
21	031301006001			1	
22	031301007001	()		1	
23	031301008001			1	
24	031301009001			1	
25	031301010001			1	
26	031301011001			1	
27	031301012001			1	
28	031301013001			1	
29	031301014001			1	
30	031301015001			1	

“ ”

B

3

3

31	031301016001					1				
32	031301017001					1				
33	031301018001					1				

“ ”

/										
1. 2.										
							-		-	
							-		-	

1.
2.

“ ” “ ”

B

2

2

				(%)	()	(%)	()	
11	031302009001			0				Q 20% Q 40%
12	LSSGCSF00001			0				“ 2015 69 ” “ 2018 3 ” “ ” Q 4%

B

\hat{U} 1 1

1

2

3

4

“ ”

11.

- 1
- 2
- 3
- 4
- 5
- 6
- 7
- 8
- 9
- 10
- 11
- 12

: _____

12

: _____

13

1

2

3

4

5

6

7